

- * **EN** Refers to water and dual fuel version
PL Dotyczy wersji wodnej i wodno-elektrycznej
CS Týká se vodní a hydroelektrické verze.
DE Betrifft die Wasser- und Wasser-Elektrischen Versionen
ES Se refiere a la versión de agua y mixta
FR Concerne la version hydraulique et mixte
IT Si riferisce alla versione idronica e mista.
NL Betreft zowel water- als water/elektrisch verwarmde versies
RU Касается версии водной и водно-электрической
SK Týka sa vodnej a hydroelektrickej verzie.

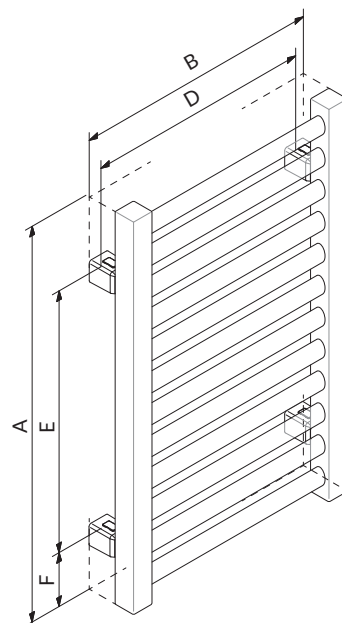

2

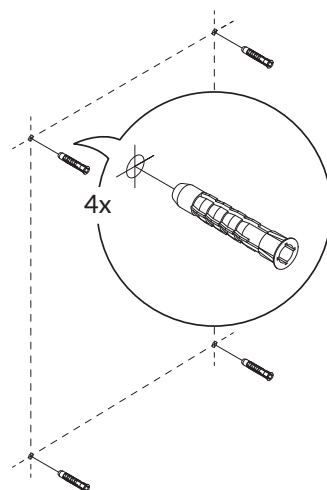

1

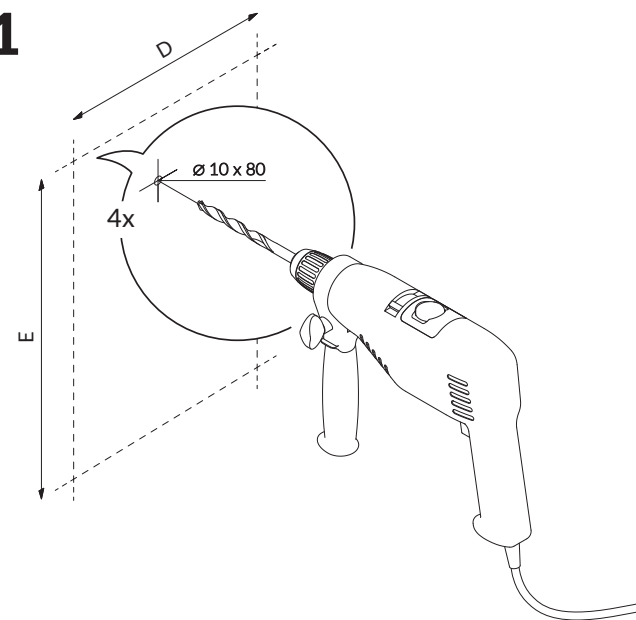

3

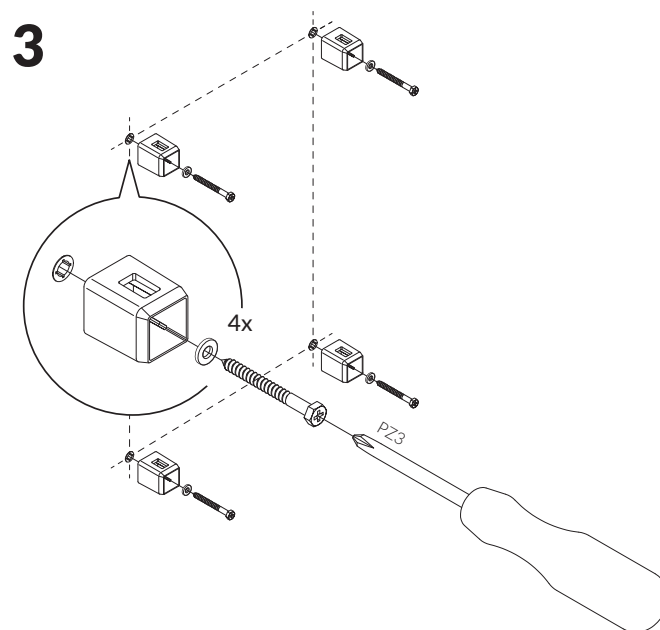

4

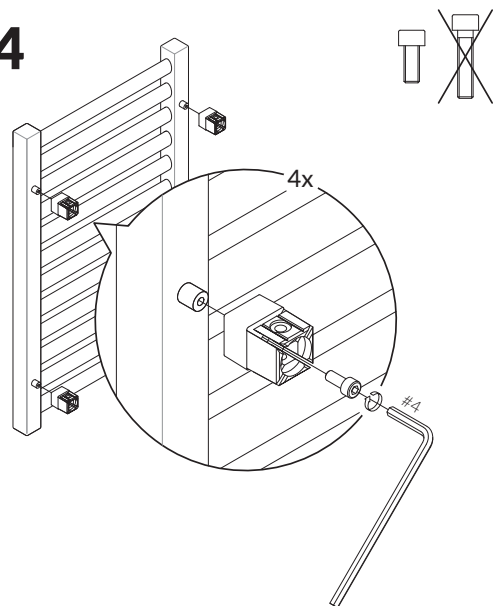

5

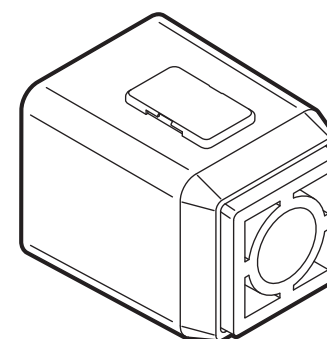
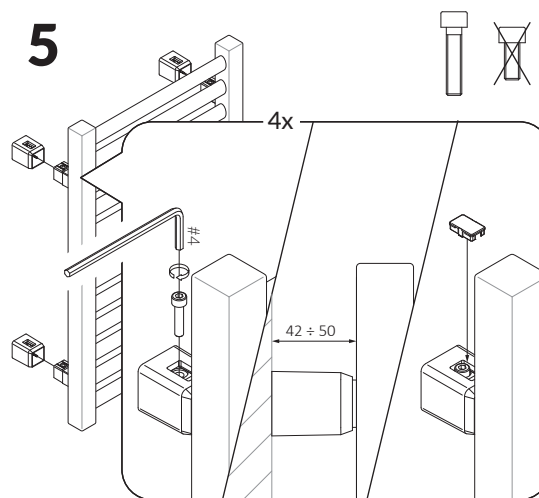

6 a/b/c*

