



SERIES DxA100



Mtrl.nr: 9814 10 52 • Ritn.nr: 7783 vers. A • Rev. 1910



Series DDA111
Series DAA111

LVD 2014/35/EU
EMC 2014/30/EU
RoHS 2011/65/EU
PED 2014/68/EU, article 4.3

ErP 2009/125/EU
ErP 2015
EnEV 2014

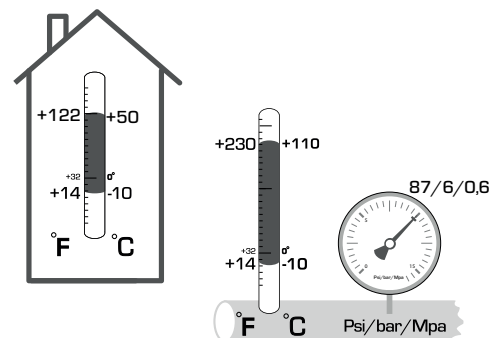

SERIES	FUNCTION
DAA111	
DDA111	



Electric installation

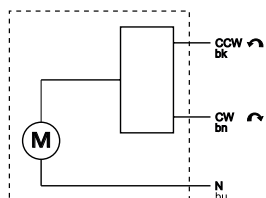
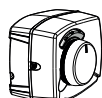
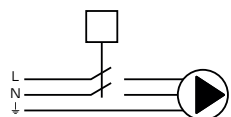
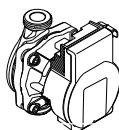

1

Remove actuator

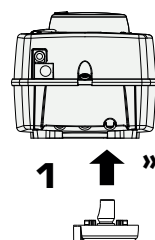
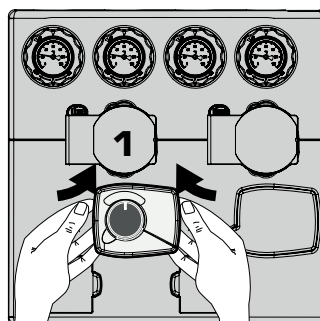

2

Disassembly insulation

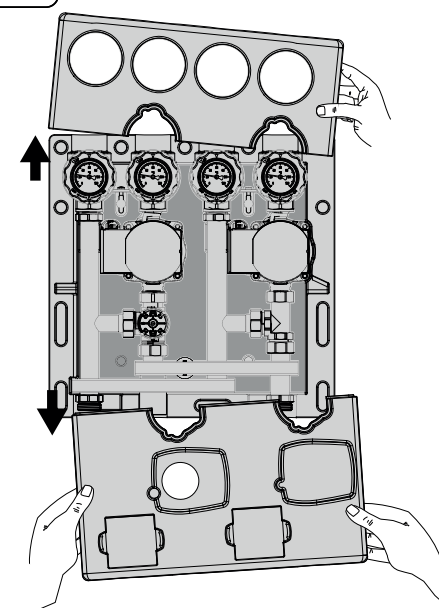

3

Wall mounting

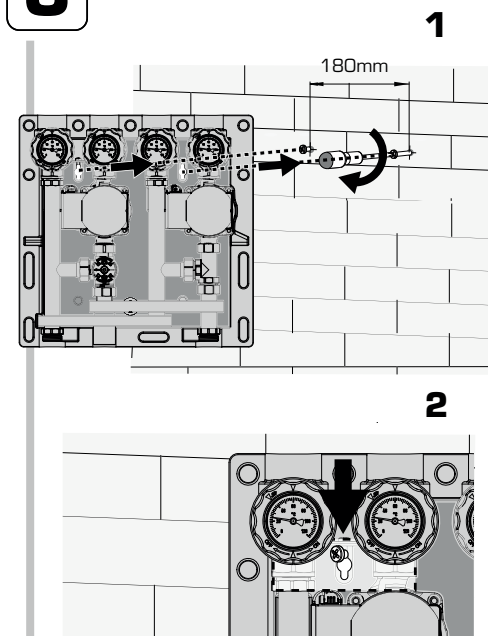

4

Connecting the pipes

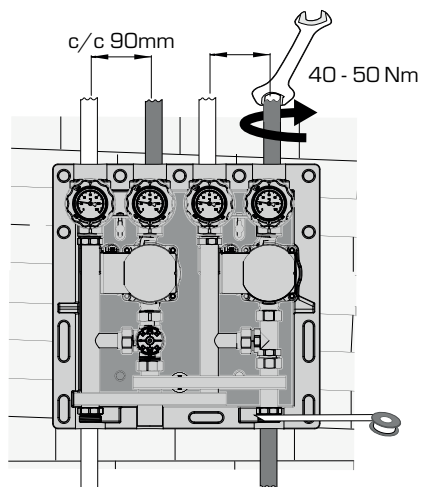

5

Mount the insulation

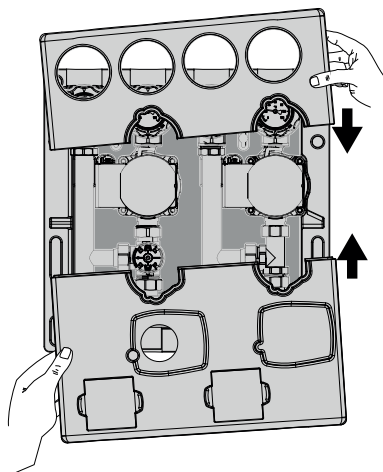

6a

Mount the actuator and cables

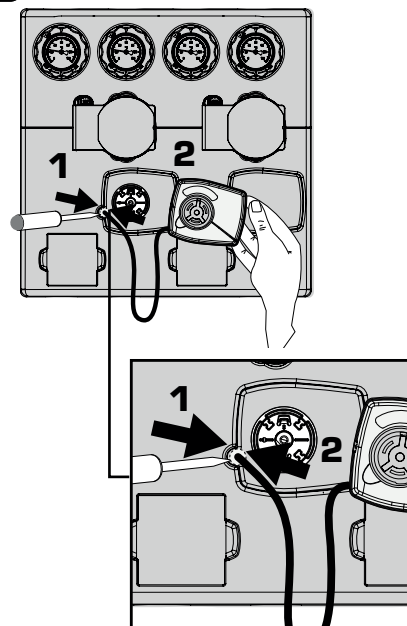

6b

Cabling

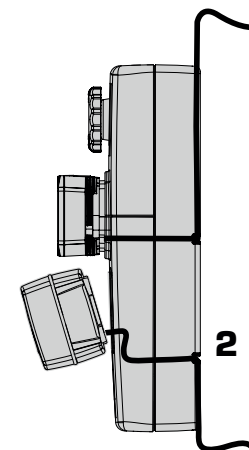

6c

Quick Fit

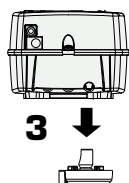
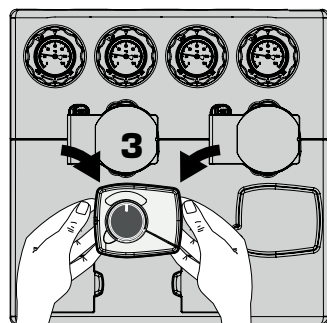

6d

Cabling • Dimensions

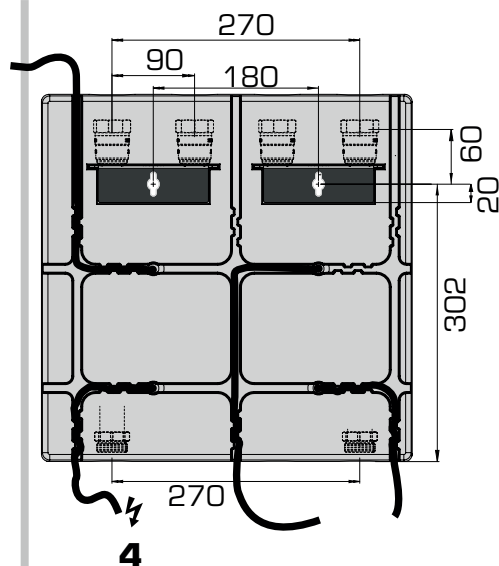

7

Mounting position

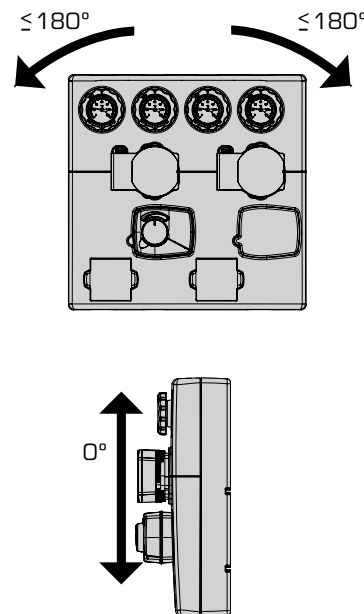

i

Application

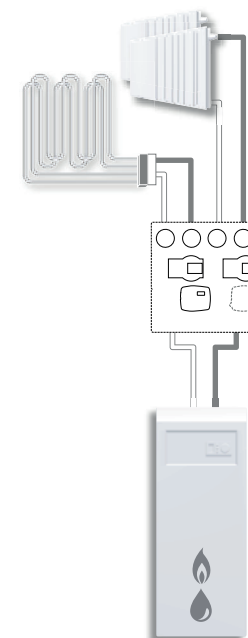

8



By-pass ON/OFF

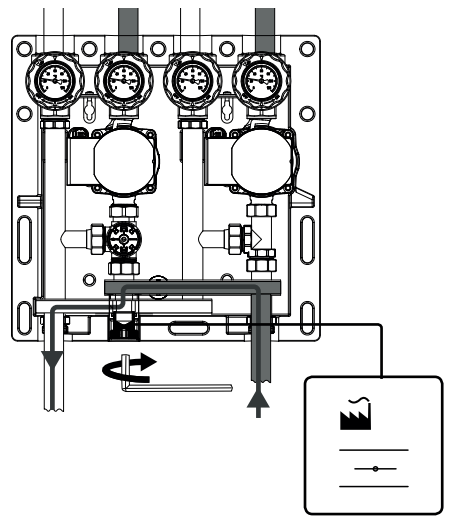

6 ↶ = By-pass closed
 6 ↷ = By-pass open

Ø10 mm

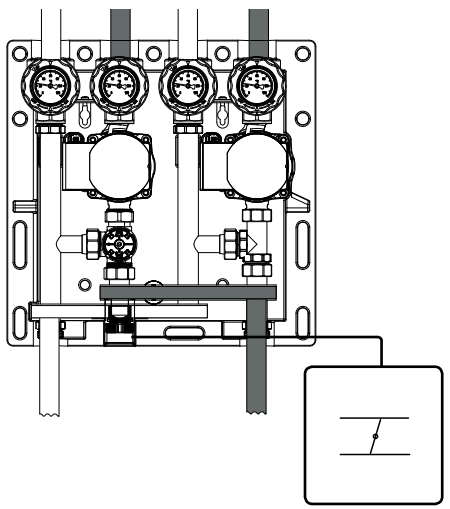

9



Display

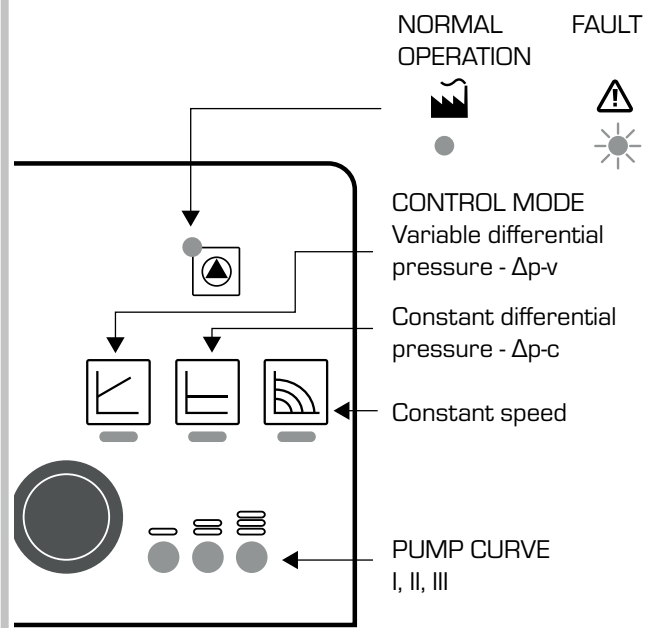

i



= Factory settings

10

Pump Settings

Click	LED display	Control mode	Pump curve
			Recommended Alternative
1		Constant speed	II
2		Constant speed	I
3		Variable differential pressure Δp-v	III
4		Variable differential pressure Δp-v	II
5		Variable differential pressure Δp-v	I
6		Constant differential pressure Δp-v	III
7		Constant differential pressure Δp-v	II
8		Constant differential pressure Δp-v	I
9		Constant speed	III

Pump features

1

2

3



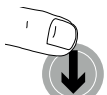

4





Hold







LED display



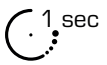

Last settings

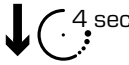
Status



Locked

Unlocked

Factory setting

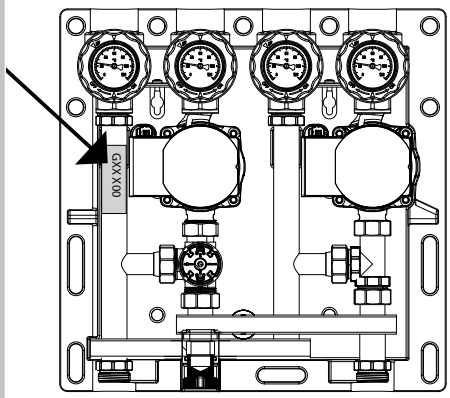

Venting

Nameplate

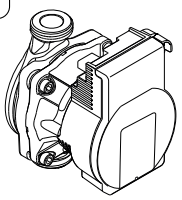
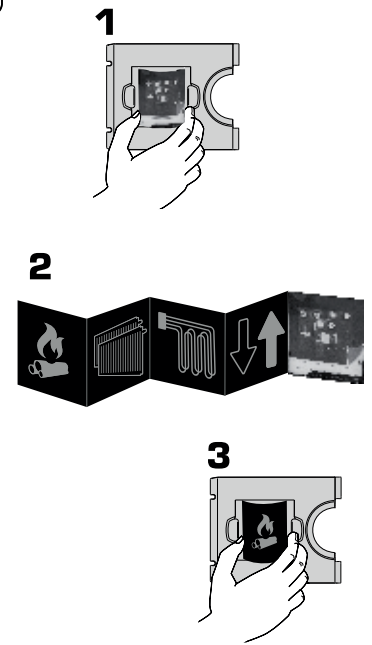

<http://www.esbe.eu/global/en/products/rotary-valves>

Leaflet information



<http://www.esbe.eu/global/en/products/circulation-units>